



## LINK BOX TECHNICAL DATA SHEET

Drw. No. **04.08.06**  
Article No. **05606001/0**

Issued Date: 12.10.2021  
Rev. Date: -  
Rev. 00

Type	LB. P . CB .3SA . 3 . 1	
- Description	Three Phase Cross Bonding Link Box for Coaxial Cable	
- Designation	Pedestal	
- Bonding	Cross-Bonding	
- Sheath Voltage Limiter	qty	3
- Phase No.	3	
- Earth	1	
<b>Drawing Number</b>	04.08.06	
- Article No	05606001/0	
<b>Electrical Characteristics</b>		
- Rated Frequency	50/60	Hz
- SVL Type (*)	Up to 10 kV / Optional	
<b>Protection Class</b>	IP 66	
<b>Material</b>		
- Enclosure	Stainless Steel AISI304 (AISI316 optional)	
- Body Thickness (**)	2 mm	
- Cover Thickness	3 mm	
- Connection Links	10 µm Tinned Electrolytic Copper	
- Connection Links Dimension	40x10 mm (400 mm <sup>2</sup> )	
- Gasket	Silicone	
- Cable Glands	3x76 mm & 1x48 mm	
- Cable Glands Insulation	Silicone gasket & EPR tape & Heat Shrinkable Tube	
- Insulation	Epoxy Support Insulator	
- Conductor Fixing	Coaxial Flexconn - 95-400 mm <sup>2</sup>	
- Painting Process	Electro Static Polyester Powder Paint	
- Painting Code	RAL 7032	
- Labeling Material	Stainless Steel	
- Protection Cover	PET-G	
<b>AC Impulse Test</b>		
- Phase-to-Phase	60	kV
- Phase-to-Earth	40	kV
<b>Voltage Withstand Test</b>		
- AC	20	kV/1 min
- DC	25	kV/5 min
<b>Short Circuit Test</b>		
- Symmetrical	50	kA/1sec
<b>Internal Power Arcing Test (Symmetrical)</b>		
	40	kA/0.1 sec

\* In case of mismatch in given values, technical drawing provided along with the Order Confirmation is valid. Ask for conformity if SVL is out of EMELEC's scope.

\*\* Body Thickness might differ related to technical drawing revision. For exact value, refer to technical drawing provided along with the Order Confirmation



## LINK BOX TECHNICAL DATA SHEET

### Bonding Cable

- Type Coaxial

Cross-Section (mm <sup>2</sup> ):	Gland Dia		A		B		C		D	
	Outer (mm)	Inner (mm)	min (mm)	max (mm)	min (mm)	max (mm)	min (mm)	max (mm)	min (mm)	max (mm)
95-400:	76	72	12	24	20	36	25	48	30	64

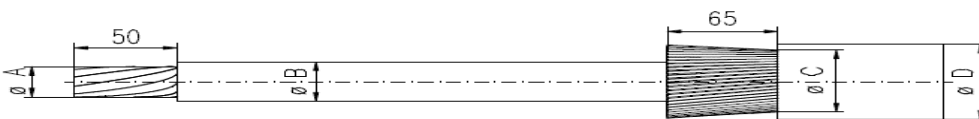

### Schematic Diagram

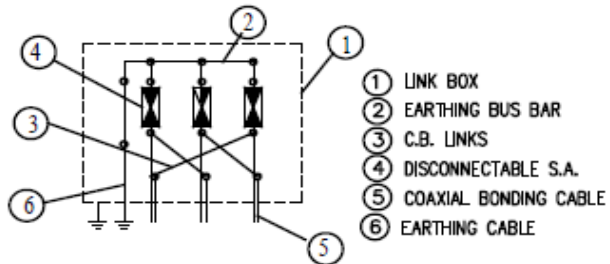

### Enclosure Dimensions (\*)

Width	630 mm
Length	810 mm
Height	370 mm
Weight	94 kg

### Filling Compound (Optional)

Volume	N/A
--------	-----

\* Scheme and dimensions are not to be mentioned as final drawing. For exact dimensions, refer to technical drawing provided along with the Order Confirmation

\*\* Given are approximate values. Actual values might slightly differ.