



## LINK BOX TECHNICAL DATA SHEET

**Drw. No. 09.12.03**  
**Article No. 12003001/0**

**Issued Date:** 12.08.2021  
**Rev. Date:** -  
**Rev.** 00

Type	LB. W . E .4SA . 4 . 1	
- Description	Four Phase Earthing Link Box for Single Cable	
- Designation	Wall Type	
- Bonding	Earthing	
- Sheath Voltage Limiter	qty	4
- Phase No.	4	
Earth	1	
<b>Drawing Number</b>	09.12.03	
- Article No	12003001/0	
<b>Electrical Characteristics</b>		
- Rated Frequency	50/60	Hz
- SVL Type (*)	Up to 10 kV / Optional	
<b>Protection Class</b>		
	IP	66
<b>Material</b>		
- Enclosure	Stainless Steel AISI304 (AISI316 optional)	
- Body Thickness (**)	2 mm	
- Cover Thickness	3 mm	
- Connection Links	10 µm Tinned Electrolytic Copper	
- Connection Links Dimension	40x10 mm (400 mm <sup>2</sup> )	
- Gasket	Silicone	
- Cable Glands	5x48 mm	
- Cable Glands Insulation	Silicone gasket & EPR tape	
- Insulation	Epoxy Support Insulator	
- Conductor Fixing	Conductor Flexconn - 95-400 mm <sup>2</sup>	
- Painting Process	Electro Static Polyester Powder Paint	
- Painting Code	RAL 7032	
- Labeling Material	Stainless Steel	
- Protection Cover	PET-G	
<b>AC Impulse Test</b>		
- Phase-to-Phase	60	kV
- Phase-to-Earth	30	kV
<b>Voltage Withstand Test</b>		
- AC	20	kV/1 min
- DC	25	kV/5 min
<b>Short Circuit Test</b>		
- Symmetrical	N/A	
<b>Internal Power Arcing Test (Symmetrical)</b>		
	40	kA/0.1 sec

\* In case of mismatch in given values, technical drawing provided along with the Order Confirmation is valid. Ask for conformity if SVL is out of EMELEC's scope.

\*\* Body Thickness might differ related to technical drawing revision. For exact value, refer to technical drawing provided along with the Order Confirmation

**Bonding Cable**

- Type Single

Cross-Section: (mm <sup>2</sup> )	Gland Dia		A		B		C		D	
	Outer (mm)	Inner (mm)	min (mm)	max (mm)	min (mm)	max (mm)	min (mm)	max (mm)	min (mm)	max (mm)
95-400	48	44	12	24	17	40	N/A	N/A	N/A	N/A

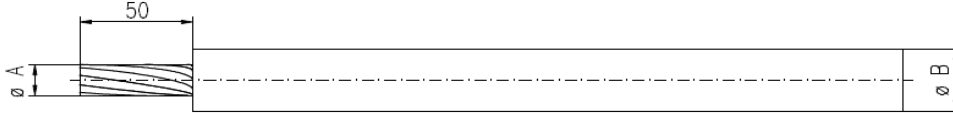

**Schematic Diagram**

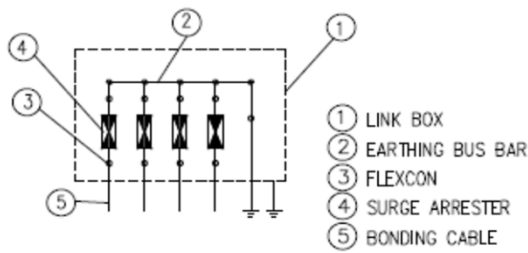

**Enclosure Dimensions (\*)**

Width	800 mm
Length	500 mm
Height	250 mm
Weight	55 kg

**Filling Compound (Optional)**

Volume	N/A
--------	-----

\* Scheme and dimensions are not to be mentioned as final drawing. For exact dimensions, refer to technical drawing provided along with the Order Confirmation

\*\* Given are approximate values. Actual values might slightly differ.