



LINK BOX TECHNICAL DATA SHEET

Drw. No. 07.04.01
Article No. 08801001/0

Issued Date: 10.05.2019
Rev. Date: 12.08.2021
Rev. 01

Type	LB. W . SB .6SA . 3 . 1
- Description	Both Ends S. Point Bonding Link Box for Coaxial Cable
- Designation	Wall Type
- Bonding	Single Point
- Sheath Voltage Limiter	qty 6
- Phase No.	3
- Earth	1
Drawing Number	07.04.01
- Article No	08801001/0
Electrical Characteristics	
- Rated Frequency	50/60 Hz
- SVL Type (*)	Up to 10 kV / Optional
Protection Class	IP 66
Material	
- Enclosure	Stainless Steel AISI304 (AISI316 optional)
- Body Thickness (**)	2 mm
- Cover Thickness	3 mm
- Connection Links	10 µm Tinned Electrolytic Copper
- Connection Links Dimension	40x10 mm (400 mm ²)
- Gasket	Silicone
- Cable Glands	3x76 mm & 1x48 mm
- Cable Glands Insulation	Silicone gasket & EPR tape
- Insulation	Epoxy Support Insulator
- Conductor Fixing	Coaxial Flexconn - 95-400 mm ²
- Painting Process	Electro Static Polyester Powder Paint
- Painting Code	RAL 7032
- Labeling Material	Stainless Steel
- Protection Cover	PET-G
AC Impulse Test	
- Phase-to-Phase	75 kV
- Phase-to-Earth	40 kV
Voltage Withstand Test	
- AC	20 kV/1 min
- DC	25 kV/5 min
Short Circuit Test	
- Symmetrical	N/A
Internal Power Arcing Test (Symmetrical)	
	40 kA/0.1 sec

* In case of mismatch in given values, technical drawing provided along with the Order Confirmation is valid. Ask for conformity if SVL is out of EMELEC's scope.

** Body Thickness might differ related to technical drawing revision. For exact value, refer to technical drawing provided along with the Order Confirmation

Bonding Cable

- Type		Coaxial									
		Gland Dia		A		B		C		D	
Outer	Inner	min	max	min	max	min	max	min	max	min	max
95-400	76	72	12	24	20	36	25	48	30	64	

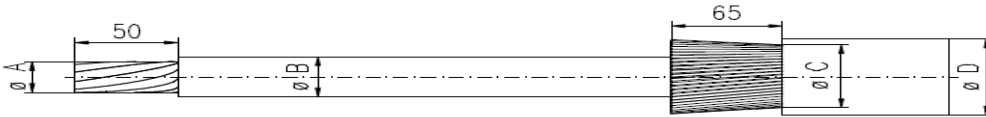

Schematic Diagram

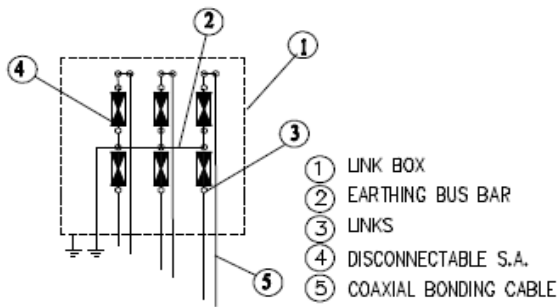

Enclosure Dimensions (*)

Width	690 mm
Length	590 mm
Height	368 mm
Weight	76 kg

Filling Compound (Optional)

Volume	N/A
--------	-----

* Scheme and dimensions are not to be mentioned as final drawing. For exact dimensions, refer to technical drawing provided along with the Order Confirmation

** Given are approximate values. Actual values might slightly differ.